

DEX-O-TEX®

www.dexotex.com

WEATHERWEAR: DECK TO ROOF TRANSITION

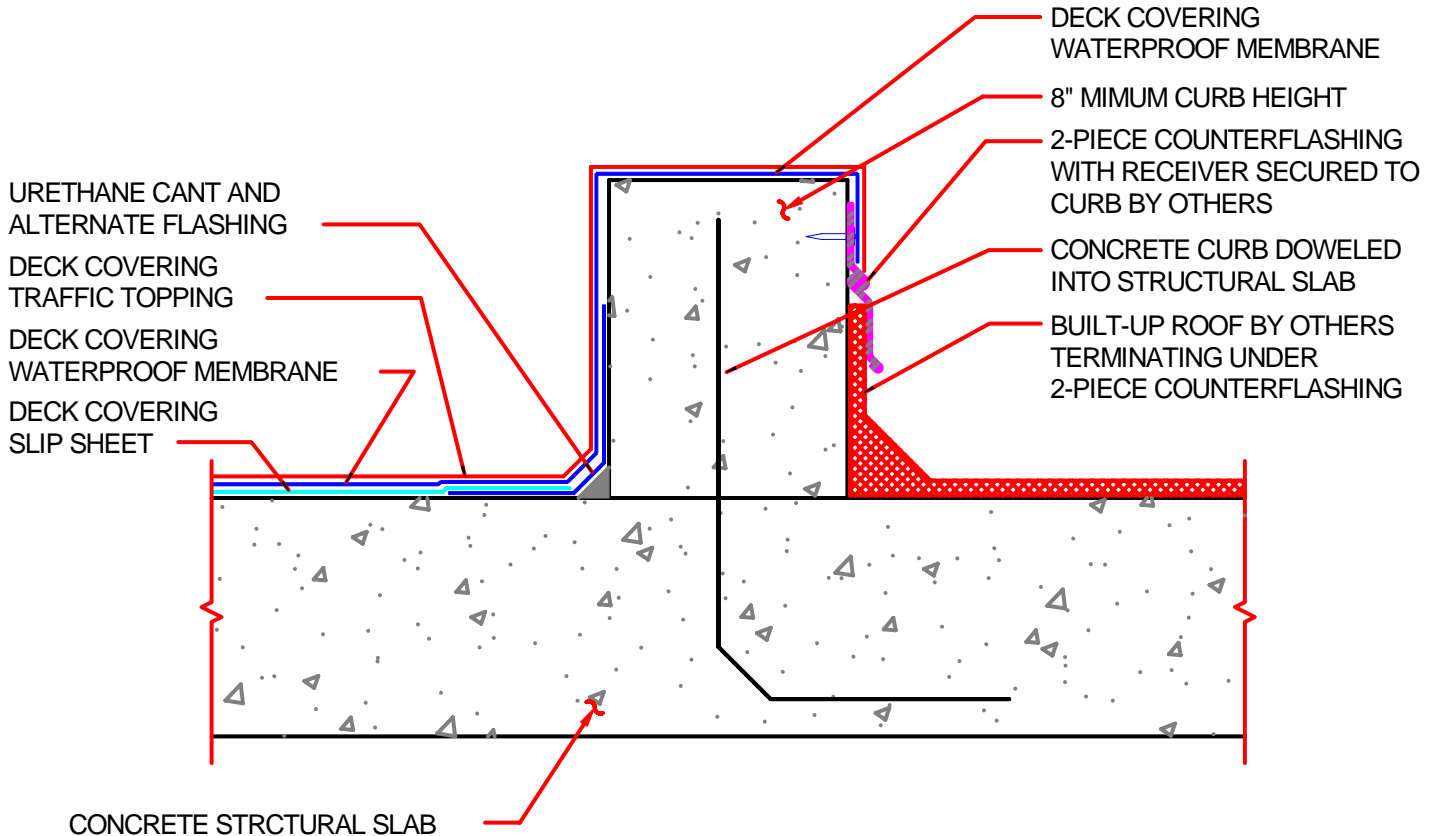

REFER TO THE FOLLOWING INSTALLATION NOTES FOR ADDITIONAL REQUIRED INFORMATION

2. CONCRETE SUBSTRATES
- 3B. SHEET METAL INSTALLATION - CONCRETE

Curb Separating Deck Covering System from Built-Up Roof - W2D



Crossfield Products Corp.
Corporate Offices
West Coast Office
3000 Harcourt Street
Rancho Dominguez, CA 90221
310-886-9100
310-886-9119 fax

East Coast Office
140 Valley Road
Roselle Park, NJ 07204
908-245-2800
908-245-0659 fax

DCH161-W2D001/01